

# KATANA<sup>®</sup>

**BRUSHLESS**  
PERFORMANCE MOTOR

## CORDLESS BRUSHLESS LAWN MOWER INSTRUCTION MANUAL

*2x 18V CHARGE-ALL*

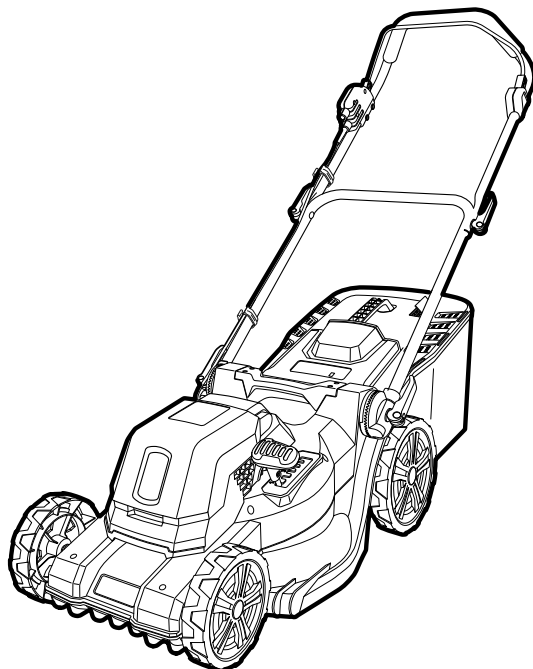

04/22

**5 YEAR  
WARRANTY\***

**2x 18V  
LITHIUM ION**

220241

## GENERAL POWER TOOL SAFETY WARNINGS

220241



**WARNING** Read all safety warnings and all instructions. Failure to follow the warnings and instructions may result in electric shock, fire and/or serious injury. **Save all warnings and instructions for future reference.** The term "power tool" in the warnings refers to your mains-operated (corded) power tool or battery-operated (cordless) power tool. The intended use is described in this manual. The use of any accessory or attachment or the performance of any operation with this appliance other than those recommended in this instruction manual may present a risk of personal injury.

### 1) Work area safety

- a) **Keep work area clean and well lit.** Cluttered or dark areas invite accidents.
- b) **Do not operate power tools in explosive atmospheres, such as in the presence of flammable liquids, gases or dust.** Power tools create sparks which may ignite the dust or fumes.
- c) **Keep children and bystanders away while operating a power tool.** Distractions can cause you to lose control.
- d) **Never allow children or people unfamiliar with the instructions to use the appliance.** Local regulations may restrict the age of the operator.

### 2) Electrical safety

- a) **Power tool plugs must match the outlet. Never modify the plug in any way. Do not use any adapter plugs with earthed (grounded) power tools.** Unmodified plugs and matching outlets will reduce risk of electric shock.
- b) **Avoid body contact with earthed or grounded surfaces, such as pipes, radiators, ranges and refrigerators.** There is an increased risk of electric shock if your body is earthed or grounded.
- c) **Do not expose power tools to rain or wet conditions.** Water entering a power tool will increase the risk of electric shock.
- d) **Do not abuse the cord. Never use the cord for carrying, pulling or unplugging the power tool. Keep cord away from heat, oil, sharp edges or moving parts.** Damaged or entangled cords increase the risk of electric shock.
- e) **When operating a power tool outdoors, use an extension cord suitable for outdoor use.** Use of a cord suitable for outdoor use reduces the risk of electric shock.
- f) **If operating a power tool in a damp location is unavoidable, use a residual current device (RCD) protected supply.** Use of an RCD reduces the risk of electric shock.

### 3) Personal safety

- a) **Stay alert, watch what you are doing and use common sense when operating a power tool. Do not use a power tool while you are tired or under the influence of drugs, alcohol or medication.** A moment of inattention while operating power tools may result in serious personal injury.

- b) **Use personal protective equipment. Always wear eye protection.** Protective equipment such as dust mask, non-skid safety shoes, hard hat, or hearing protection used for appropriate conditions will reduce personal injuries.
- c) **Prevent unintentional starting. Ensure the switch is in the off-position before connecting to power source and/or battery pack, picking up or carrying the tool.** Carrying power tools with your finger on the switch or energising power tools that have the switch on invites accidents.
- d) **Remove any adjusting key or wrench before turning the power tool on.** A wrench or a key left attached to a rotating part of the power tool may result in personal injury.
- e) **Do not overreach. Keep proper footing and balance at all times.** This enables better control of the power tool in unexpected situations.
- f) **Dress properly. Do not wear loose clothing or jewellery. Keep your hair, clothing and gloves away from moving parts.** Loose clothes, jewellery or long hair can be caught in moving parts.
- g) **If devices are provided for the connection of dust extraction and collection facilities, ensure these are connected and properly used.** Use of dust collection can reduce dust-related hazards.

### 4) Power tool use and care

- a) **Do not force the power tool. Use the correct power tool for your application.** The correct power tool will do the job better and safer at the rate for which it was designed.
- b) **Do not use the power tool if the switch does not turn it on and off.** Any power tool that cannot be controlled with the switch is dangerous and must be repaired.
- c) **Disconnect the plug from the power source and/or the battery pack from the power tool before making any adjustments, changing accessories, or storing power tools.** Such preventive safety measures reduce the risk of starting the power tool accidentally.
- d) **Store idle power tools out of the reach of children and do not allow persons unfamiliar with the power tool or these instructions to operate the power tool.** Power tools are dangerous in the hands of untrained users.
- e) **Maintain power tools. Check for misalignment or binding of moving parts, breakage of parts and any other condition that may affect the power tool's operation. If damaged, have the power tool repaired before use.** Many accidents are caused by poorly maintained power tools.
- f) **Keep cutting tools sharp and clean.** Properly maintained cutting tools with sharp cutting edges are less likely to bind and are easier to control.
- g) **Use the power tool, accessories and tool bits etc. in accordance with these instructions, taking into account the working conditions and the work to be performed.** Use of the power tool for operations different from those intended could result in a hazardous situation.

### 5) Battery tool use and care

- a) **Recharge only with the charger specified by the manufacturer.** *A charger that is suitable for one type of battery pack may create a risk of fire when used with another battery pack.*
- b) **Use power tools only with specifically designated battery packs.** *Use of any other battery packs may create a risk of injury and fire.*
- c) **When battery pack is not in use, keep it away from other metal objects, like paper clips, coins, keys, nails, screws or other small metal objects, that can make a connection from one terminal to another.** *Shorting the battery terminals together may cause burns or a fire.*
- d) **Under abusive conditions, liquid may be ejected from the battery; avoid contact. If contact accidentally occurs, flush with water. If liquid contacts eyes, additionally seek medical help.** *Liquid ejected from the battery may cause irritation or burns.*

### 6) Service

- a) **Have your power tool serviced by a qualified repair person using only identical replacement parts.** *This will ensure that the safety of the power tool is maintained.*

### 7) Battery Tool Use And Care

*Recharge only with the charger specified by the manufacturer. A charger that is suitable for one type of battery pack may create a risk of fire when used with another battery pack.*

- a) **Use power tools only with specifically designated battery packs.** *Use of any other battery packs may create a risk of injury and fire.*
  - b) **When battery pack is not in use, keep it away from other metal objects, like paper clips, coins, keys, nails, screws or other small metal objects, that can make a connection from one terminal to another.** *Shorting the battery terminals together may cause burns or a fire.*
  - c) **Under abusive conditions, liquid may be ejected from the battery; avoid contact. If contact accidentally occurs, flush with water. If liquid contacts eyes, additionally seek medical help.** *Liquid ejected from the battery may cause irritation or burns.*
- 8) **Additional Safety Instructions Lawn Mowers**
- a) **This product is not intended for use by persons (including children) with reduced physical, sensory or mental capabilities, or lack of experience and knowledge, unless they have been given supervision or instruction concerning use of the product by a person responsible for their safety.**
  - b) **Children should be supervised to ensure that they do not play with the product. Cleaning and user maintenance shall not be made by children without supervision.**
  - c) **Read the instructions carefully.** *Be familiar with the controls and the proper use of the product. Never allow children or people unfamiliar with these instructions to use the product. Local regulations can restrict the age of the operator.*
  - d) **Never mow while people, especially children, or pets are nearby. Keep in mind that the operator or user is responsible for accidents or hazards occurring to other people or their property.**
  - e) **Mow across the face of slopes, never up and down.**
  - f) **Exercise extreme caution when changing direction on slopes. Do not mow excessively steep slopes.**
  - g) **Use extreme caution when reversing or pulling the product towards you. Stop the cutting device(s) if the product has to be tilted for transportation when crossing surfaces other than grass, and when transporting the product to and from the area to be mowed.**
  - h) **Never operate the product with defective guards, or without safety devices, for example deflectors and/or grass catchers, in place.**
  - i) **Start the product or switch on the product carefully according to instructions and with feet well away from the cutting device(s).**
  - j) **Do not tilt the product when switching on the motor, except if the product has to be tilted for starting. In this case, do not tilt it more than absolutely necessary and lift only the part, which is away from the operator.**
  - k) **Do not start the product when standing in front of the discharge chute.**
  - l) **Do not put hands or feet near or under rotating parts. Keep clear of the discharge opening at all times.**
  - m) **Never pick up or carry a product while the safety key is inserted. Stop the machine, and remove the disabling device. Make sure that all moving parts have come to a complete stop.**
    - *Whenever you leave the product.*
    - *Before clearing blockages or unclogging chute.*
    - *Before checking, cleaning or working on the product.*
    - *After striking a foreign object. Inspect the machine for damage and make repairs before restarting and operating the product;*  
*if the product starts to vibrate abnormally (check immediately).*
    - *Inspect for damage.*
    - *Replace or repair any damaged parts.*
    - *Check for and tighten any loose parts.*
  - n) **Replace worn or damaged blades and bolts in sets to preserve balance.**
  - o) **The blade on the product is sharp. Use extreme caution and wear heavy-duty gloves when fitting, replacing, cleaning, or checking bolt security.**
  - p) **Contact an authorised service centre to replace damaged or unreadable labels.**
  - q) **Check all nuts, bolts, and screws at frequent intervals for proper tightness to be sure that the product is in safe working condition.**
  - r) **Frequently check the grass catcher for wear, holes, or deterioration.**

**KNOW YOUR PRODUCT**

220241

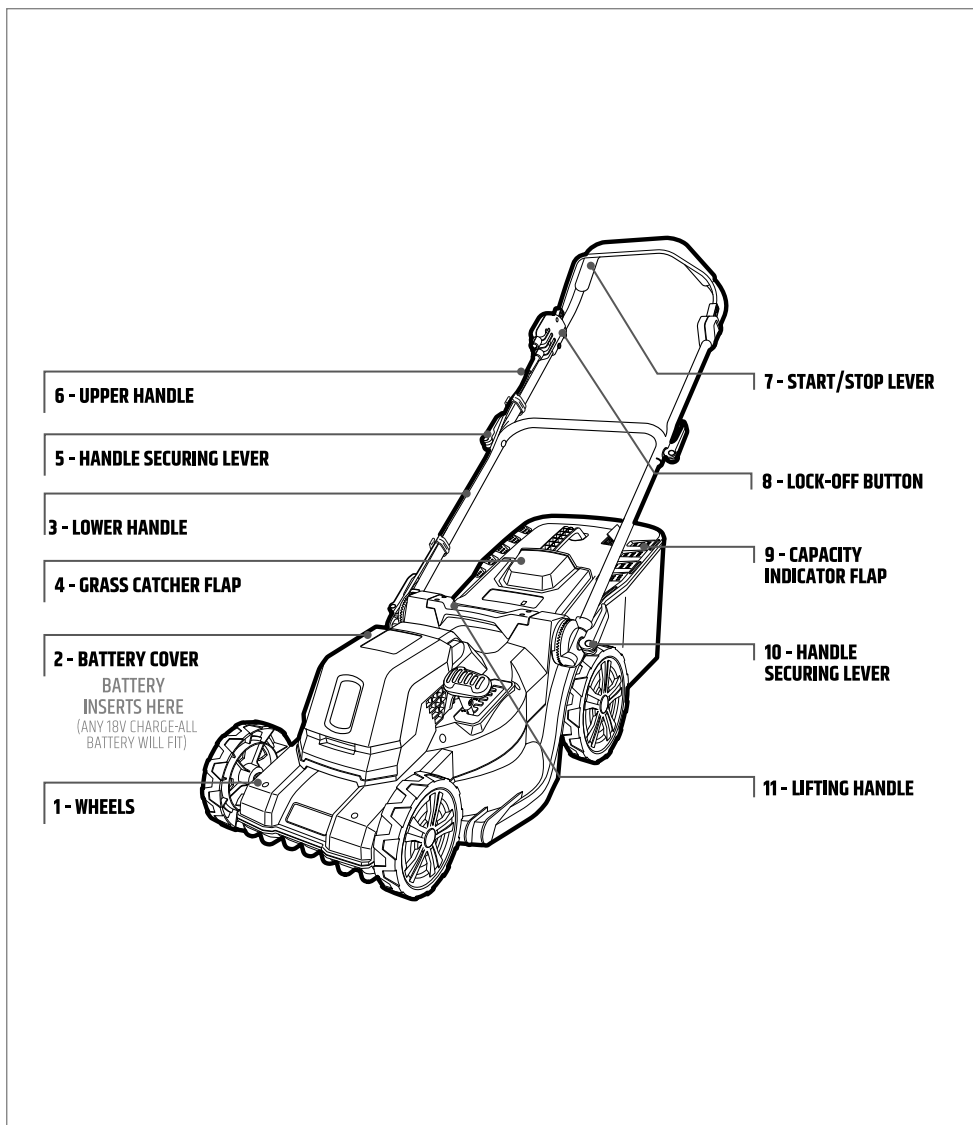
**SPECIFICATIONS**

<b>Voltage</b>	36V (2 x 18V)	<b>No load speed</b>	3,500rpm
<b>Cutting Width</b>	400 mm	<b>Height Settings</b>	6 (25mm to 75mm)

## INSERTING AND REMOVING BATTERY

220241

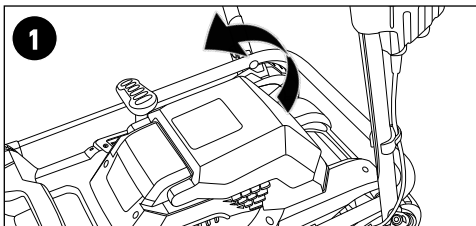

1. Open the battery cover.

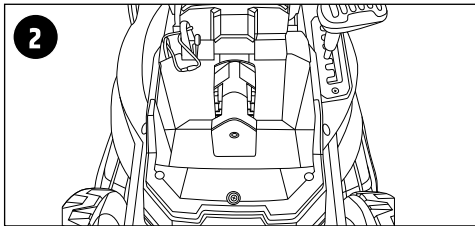

2. Slide the battery into the mower aligning the ribs so that it clicks into place.

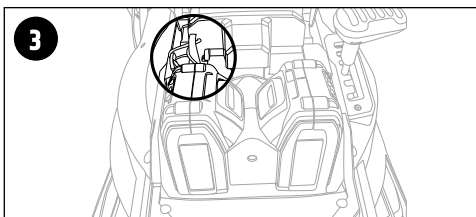

3. Insert the safety key (If the mower is not going to be used immediately, do not insert the safety key).



4. Close the battery cover.

## REMOVING THE BATTERY FROM THE MOWER

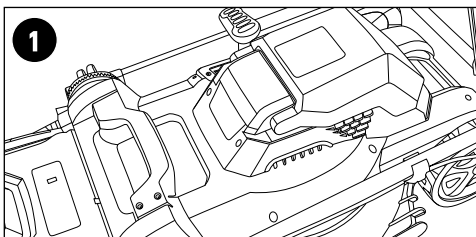

1. Open the battery cover.

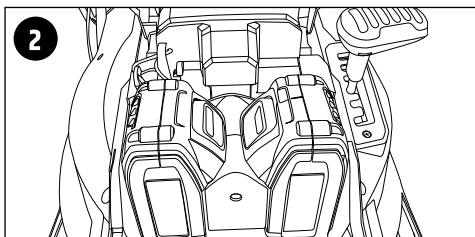

2. Press the battery release tab and remove the battery.

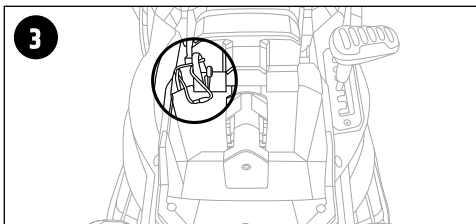

3. Remove the safety key.

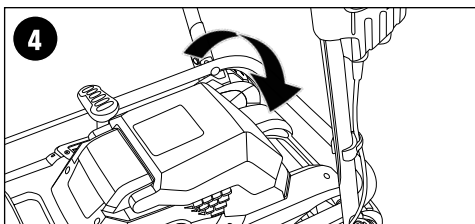

4. Close the battery cover.

## FITTING THE LOWER HANDLES

220241



### WARNING

ENSURE THE TOOL IS SWITCHED OFF, SAFETY KEY REMOVED AND BATTERIES ARE DISCONNECTED BEFORE PERFORMING ANY OF THE FOLLOWING TASKS.

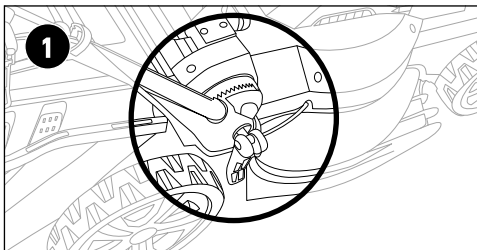

1. Align the mounting hole of the lower handle with the bolt of handle.

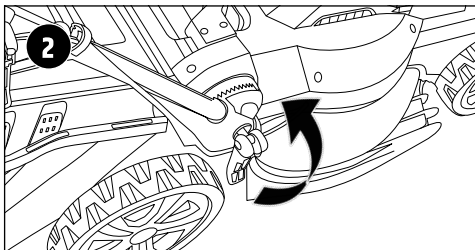

2. Secure the handle by tightening the securing levers. Make sure that the control cord runs up the upper side of the handle bar.

## FITTING THE UPPER HANDLE

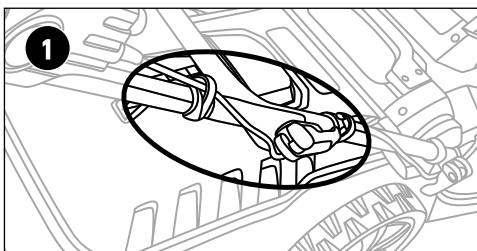

1. Align the upper section to the lower section and ensure the foam handle is pointed up when viewed from behind. Pass the bolts through the mounting holes of both handles from the inner side with the thread exposed on the outer.

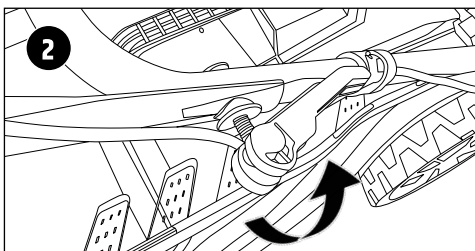

2. Secure in place by screwing the handle securing levers over the protruding ends of the bolts.

## SECURING THE CORD TO THE HANDLE

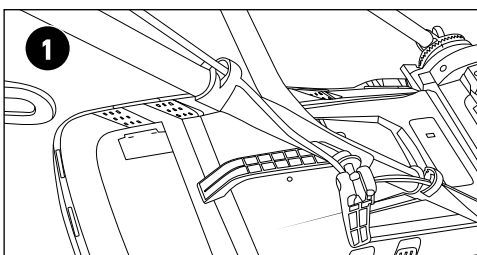

1. Ensure the cord follows the handle smoothly from the switch to the body of the mower. Locate the cord on the outside of the handle.

Secure the power cord from the switch housing to the mower using 2 cable ties (supplied). Care should be taken when folding down the handle for storage.

**GRASS CATCHER ASSEMBLY**

220241

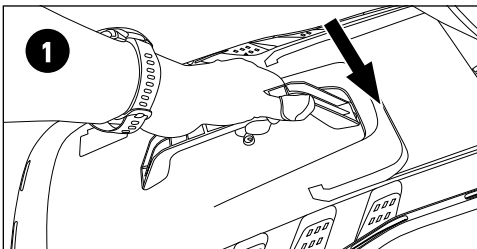

1. To assemble the grass catcher align the handle with the holes on top of the body & insert until you hear a click. Catcher is not ready for use.



**WARNING**

ONLY FIT AND REMOVE THE CATCHER WHEN THE MOWER IS SWITCHED OFF AND THE MOTOR HAS COME TO A STOP.

**FITTING AND REMOVING THE GRASS CATCHER**

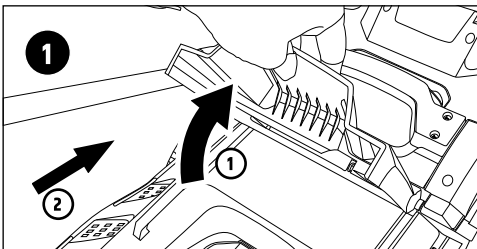

1. Lift up the catcher flap with one hand and guide the catcher with your other hand over the two hooks on the mower housing. Lower the grass catcher and allow it to sit in place and lower the catcher flap.

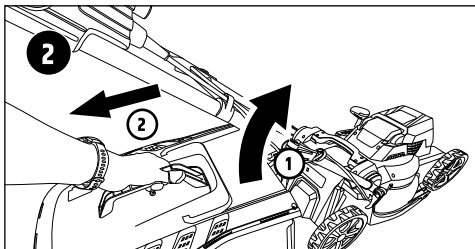

2. To remove, raise the flap and lift the catcher out.

## SWITCHING ON AND OFF

220241

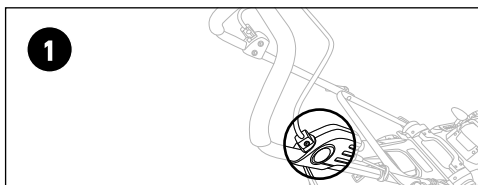

1. To prevent accidental start up, the mower is fitted with a dual action switch. Press and hold the lock-off button.

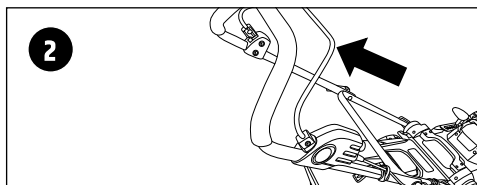

2. Pull the start/stop lever towards the handle to start the mower and then release the lock-off button. To stop the mower, release the start/stop lever.

## ADJUSTING THE CUTTING HEIGHT

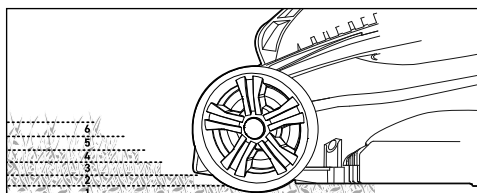
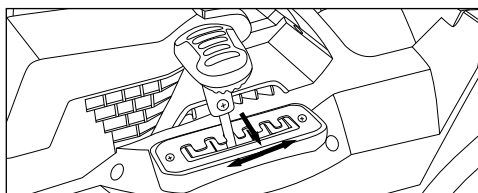

### WARNING

**DO NOT USE MOWER IN POOR VISIBILITY CONDITIONS, IN THE RAIN OR WHEN GRASS IS WET.**

To obtain the desired cutting height, the front and rear axles are repositioned on the underside of the mower housing.

To adjust the deck height, pull the height adjustment lever towards the wheel, then raise or lower the deck to the preferred height. Make sure that the handle is always secured into one of the six height slots.

## MOWING

- While using your lawn mower always wear substantial closed, heavy footwear and long trousers.
- Make sure the lawn is clear of sticks, stones, wire and debris; they could be thrown by the blade.
- Before using the lawn mower and after any impact, check for signs of wear or damage and repair as necessary.
- Do not cut wet grass because it tends to stick to the underbody of the mower, preventing the proper discharge of grass clippings, and it could also cause you to slip and fall.
- Replace a worn or damaged blade together with the blade bolt to preserve balance.
- Never cut off more than one-third of the total length of the grass for a healthy lawn. In the autumn, lawns should only be cut as long as there is growth.
- Slowly push the mower forward.
- Mow in slight overlapping rows. The most effective pattern for mowing lawns is straight lines along one of the sides. This will keep the rows even and ensures that all the lawn is cut without missing any spots.
- Circle around flower beds. When reaching a flower bed in the middle of the lawn, cut a row or two around the circumference of the bed.
- Pay special attention when changing direction.
- Empty the grass catcher regularly.

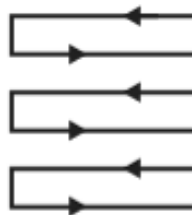

### WARNING

**DO NOT USE MOWER IN POOR VISIBILITY CONDITIONS, IN THE RAIN OR WHEN GRASS IS WET.**



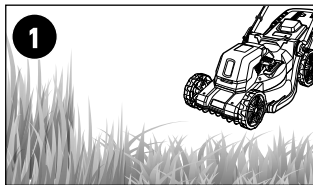

## Lawn Mowing Tips

1. Start mowing the edge of the lawn and work along making sure to overlap each pass by a few centimetres.

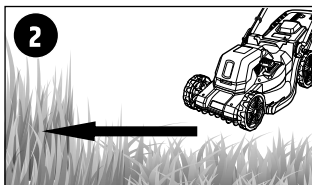

2. For optimum grass collection, always mow in a straight line; do not swing the lawn mower from side to side.

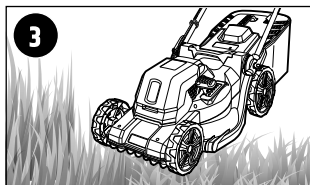

3. When mowing long grass be sure to not overload the motor. First cut with the highest cutting height and then to the desired height. This will help reduce the load.

## MAINTENANCE



### WARNING

**ALWAYS ENSURE THE LAWN MOWER BLADE HAS COMPLETELY STOPPED, REMOVE SAFETY KEY, BATTERY AND GRASS CATCHER PRIOR TO ANY MAINTENANCE. ALWAYS USE GLOVES WHEN HANDLING THE BLADE. SHARP EDGES COULD CAUSE INJURY.**

## Removing and Fitting the Blade

1. To remove the blade, hold the blade firmly and with a 13mm socket loosen the blade nut by turning it anti-clockwise.

**Note:** A piece of timber will assist in holding the blade while removing or tightening the blade bolt.

2. Remove the blade screw, washer and blade. Replace the metal blade after 50 hours mowing or 2 years whichever is sooner.

**Caution:** If the blade is cracked or damaged replace it with a new one.

3. To fit the blade, place the blade over the centre hole aligning the lugs.

4. Then retighten the blade nut with the universal wrench supplied by tightening the blade nut in a clockwise direction. The tightening torque should be approx. 25 Nm.

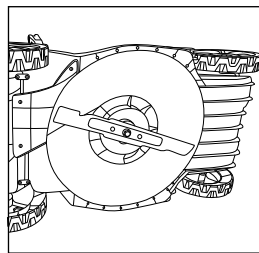

## Cleaning, Maintenance and Storage

- Keep all nuts, bolts and screws tight to be sure the lawn mower is in a safe working condition.
- Check the catcher frequently for wear or deterioration.
- Replace worn or damaged parts for safety.
- Only use the replacement blade and blade bolt specified for this product.
- Be careful during adjustments of the lawn mower to prevent entrapment of the fingers between moving blade and fixed parts of the machine.
- When not in use, the mower should be stored in a dry, frost-free location, out of reach of children. If the housing of the mower requires cleaning, do not use solvents but a moist soft cloth and brush only.
- Frequently check the wheel threads are firm and tight.

## Battery Protection System

The tool is equipped with the battery protection system, which helps to ensure a long service life.

The output power automatically cuts off during operation when the tool and/or battery are placed under the following situations:

### When the tool is overloaded

If this occurs, release the start/stop lever safety key and batteries and remove causes of overload, then reinsert the safety key and batteries. Then press and hold the lock-off button and pull the start stop lever again to restart.

### When the remaining battery capacity becomes low

When the remaining battery capacity becomes low, recharge the battery pack.

## TROUBLESHOOTING

220241

Problem	Cause	Remedy
Mower is not starting	Possible clogging	Check underneath the mower and clear out as necessary
	Battery is low in charge	Charge battery
	Battery not inserted properly	Insert battery pack correctly
	Grass too long	Raise the cutting height to reduce starting load
	Safety key not inserted correctly	Fit correctly
	Battery in overload protection mode	Remove and refit batteries or safety key
Mower is hard to push	Height of cut too low	Raise cutting height
	Cutting blade blunt	Replace blade
	Possible clogging	Check underneath the mower and clear out as necessary
	Grass too long	Raise the cutting height and walk slower
	Grass too dense	Raise the cutting height and walk slower and cut more frequently
	Wet grass	Wait until the grass dries before mowing
Motor stops while cutting	Height of cut too low	Raise the cutting height
	Battery has no power	Charge battery
Mower is not catching grass properly	Height of cut too low	Raise the cutting height
	Wet grass	Wait until the grass dries before mowing
	Catcher full	Empty catcher
Mower vibrating	Bent or damaged blade	Replace blade

## SYMBOLS

220241

The rating plate on your tool may show symbols. These represent important information about the product or instructions on its use.

	Direct current, DC		Waste electrical products should not be disposed of with household waste. Please recycle where facilities exist. Check with your Local Authority or retailer for recycling advice.
	Refer to instruction manual/booklet		
	Wear ear protection		General warning
	Wear eye protection		Regulator compliance mark
	Beware of thrown or flying objects. Keep all bystanders at least 15 m away.		Do not expose the product to rain or wet conditions.
	Cutting device continues to rotate after the product is switched off. Wait until all machine components have completely stopped before touching the product.		Rotating blades. Keep hands and feet out of the openings while the product is running.

# KATANA®

## Australia & Global

[www.katanapowertools.com.au](http://www.katanapowertools.com.au)

[enquiries@katanapowertools.com.au](mailto:enquiries@katanapowertools.com.au)

+61 3 9730 7100

Made to Katana specifications and quality standards in China.

NOT INTENDED  
FOR TRADE USE

**5 YEAR  
WARRANTY\***

\* All Katana power tools come with a 5 year (3+2 year) replacement warranty from date of purchase.

3 year standard warranty with the option to register your product online at [www.katanapowertools.com.au](http://www.katanapowertools.com.au)/register to receive an additional 2 years free of charge.

Products must be registered within 30 days from date of purchase to qualify for warranty extension.

Kincrome guarantees Katana products against faulty workmanship and materials. Kincrome will, at their discretion replace faulty products free of charge. This guarantee does not cover product that has been altered, misused, abused, subjected to normal wear and tear, used for commercial or trade use or not used in accordance with product guidelines.

Warranty is given by Kincrome Australia Pty Ltd of 3 Lakeview Drive, Caribbean Park, Scoresby, Victoria (Tel 1300 657 528). If this product has materials or workmanship defects (other than defects caused by abnormal or non-warranted use) you can, at your cost, send the product to the above address for replacement. Your rights under this warranty are in addition to any other rights you have under the Australian Consumer Law or other applicable laws. Kincrome goods come with guarantees that cannot be excluded under the Australian Consumer Law. You are entitled to a replacement or refund for a major failure.