



# OWNER'S MANUAL

## 12V or 24V Submersible Pump Kit

50000  
12V Pump  
50001  
24V Pump

September 2022

### Description

The 50000 Series DC Submersible Pump Kits are designed for transferring diesel, water, coolant or light oils up to SAE20 in a submerged environment for quick transfer jobs. Each kit is supplied complete with pump, 4 metres of  $\frac{3}{4}$ " ID rubber hose, manual nozzle and 4 metres of battery cable with on/off switch and clamps. The pump is capable of delivering flow rates of up to 32 litres per minute with a 20 minute duty cycle and has a working life of approximately 500 to 600 hours.

The pump has the latest aluminium alloy shell with shell thickness increased making the housing stronger and which also helps protect the casing from rust and corrosion. The base of the filter has a stainless steel screen filter which assists in keeping the pump and fluid free from contamination.

The new 50000 Series, DC Submersible Pump Kits are ideal as a handy all purpose transfer pump and are widely used in a variety of industries including transport & construction, farming, agriculture, workshops, boating & fishing.

Also available as 12V & 24V pump only versions as below.

### Specifications

Uses:	Transferring diesel, oil up to SAE20, ATF or fresh water and is widely used in a variety of industries including mining, construction, agriculture, transport and fishing
Discharge Quantity:	Up to 32L/min
Materials:	Aluminium alloy shell
Motor Speed:	8700R/min
Rated Voltage:	12V Pump maximum load current of 8A power 96W 24V Pump maximum load current of 5A power 110W
Pump Life:	Approximately 500-600 hours
Delivery Cycle:	20 minute

- 1 The pump should be clean and flushed to eliminate any contamination before submersing completely into the clean oil (or water).
- 2 After use, the pump should be removed from the oil (or water).
- 3 The DC12 Volt or DC24 Volt motor is fast with low noise.
- 4 Good seals ensure no leakage prolonging the service life.
- 5 With the latest aluminium alloy shell, shell thickness is increased making the housing stronger and harder to deform. The aluminium alloy shell prevents the casing from rust and corrosion.
- 6 At the base of the pump is a stainless steel filter screen preventing contamination. The filter is threaded for convenient disassembly, repair and replacement.
- 7 Power supply comes with a second midway switch for convenient operation.
- 8 Pump outlet diameter 19.5mm, delivers up to 30L/min.
- 9 Outlet diameter of the oil hose 19mm-20mm.
- 10 The pump is suitable for transferring diesel, oil up to SAE20, ATF, petrol, kerosene, alcohol or water.

### Cautions

- **IMPORTANT! Do not exceed 20 minutes continuous run time.**
- When pumping diesel, petrol, kerosene, alcohol or any other flammable liquids, open the nozzle before using the pump. Stem and pump with no-load operation.
- Before use confirm whether the power and pump labelling voltage line has a voltage tolerance of  $\pm 5\%$ . Note the positive and negative pole.

Also available: 12V Pump only - Part No: 50040  
24V Pump only - Part No: 50041



NSW/ACT  
TEL: (02) 9677 1555  
FAX: (02) 9675 1155

QLD/PNG  
TEL: (07) 3204 9166  
FAX: (07) 3204 1224

VIC/TAS  
TEL: (03) 8787 8288  
FAX: (03) 8787 8266

WA  
TEL: (08) 9302 4199  
FAX: (08) 9303 2095

SA/NT  
TEL: (08) 8241 7111  
FAX: (08) 8241 7011

NZ  
TEL: (09) 447 1007  
FAX: (09) 447 1008

# Parts & Drawing Breakdown 50000 /50001

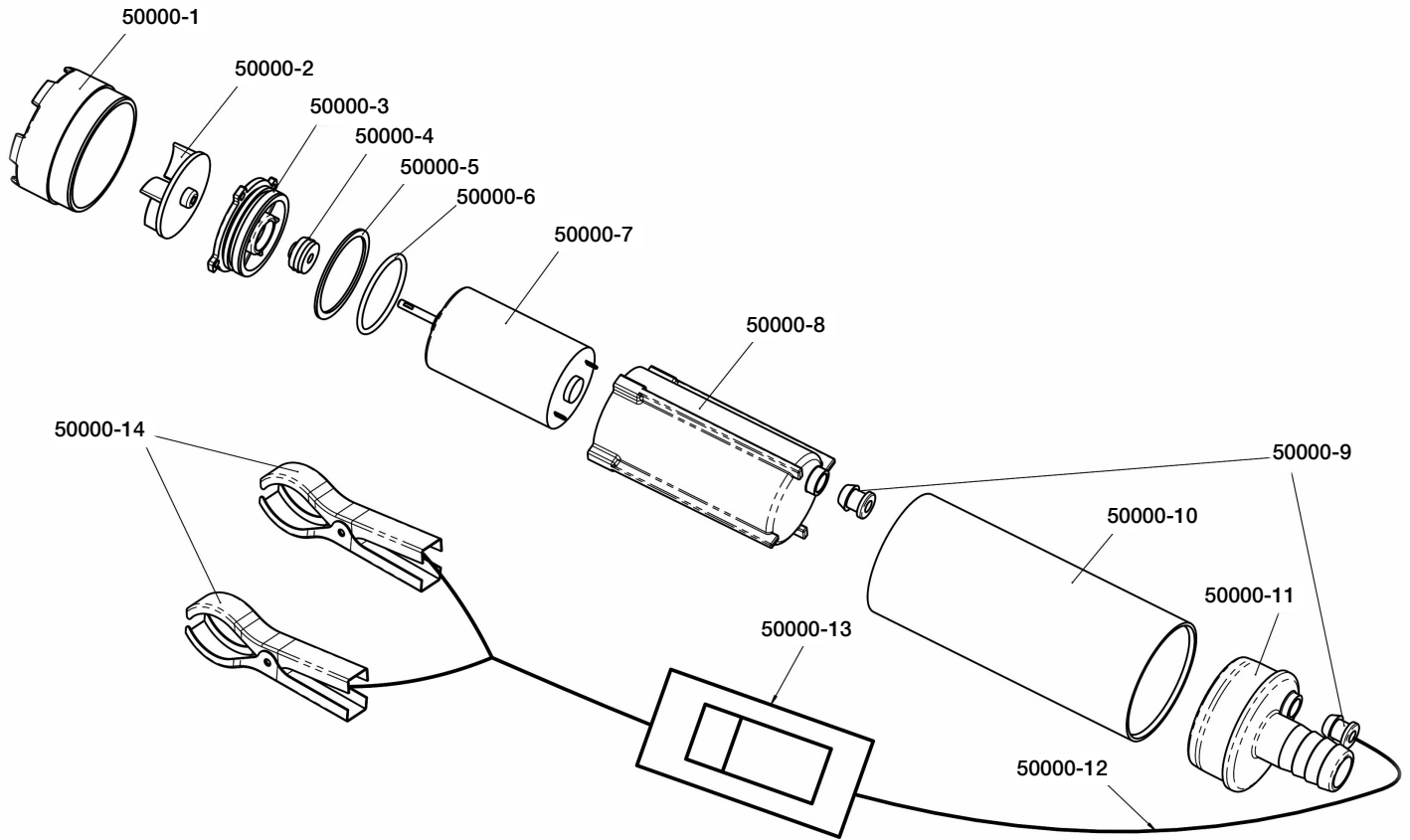

## Ordering Spare Parts

### Parts List – Part No. 50000

Part No.	Description	Qty
50000-1	Oil Filter	1
50000-2	Wind Leaf	1
50000-3	Motor Seal Cover	1
50000-4	Lock Ring	1
50000-5	Sealing Gasket	1
50000-6	O-Ring	1
50000-7	Motor	1
50000-8	Motor Insulation Cover	1
50000-9	Seal Cartridge	2
50000-10	Aluminium Alloy Shell	1
50000-11	Oil Cover	1
50000-12	Two Core Power Line	1
50000-13	Midway through the Switch Gear	1
50000-14	Positive and Negative Battery Clip	2

### Technical Parameters

**Voltage:** 12V  
**Maximum Current:** 8A  
**Power:** 96W  
**Traffic:** 32L/min

**Voltage:** 24V  
**Maximum Current:** 5A  
**Power:** 120W  
**Traffic:** 32L/min

**NSW/ACT**  
 TEL: (02) 9677 1555  
 FAX: (02) 9675 1155

**QLD/PNG**  
 TEL: (07) 3204 9166  
 FAX: (07) 3204 1224

**VIC/TAS**  
 TEL: (03) 8787 8288  
 FAX: (03) 8787 8266

**WA**  
 TEL: (08) 9302 4199  
 FAX: (08) 9303 2095

**SA/NT**  
 TEL: (08) 8241 7111  
 FAX: (08) 8241 7011

**NZ**  
 TEL: (09) 447 1007  
 FAX: (09) 447 1008