

**Makita**

# 18V Brushless 185mm (7-1/4") Circular

DHS780 - DHS781



**18Vx2 18V + 18V 36V**  
**BRUSHLESS**



**WIRELESS, ON DEMAND, DUST EXTRACTION**

Makita's Auto-start Wireless System (AWS) has modernised on-demand dust extraction to meet the needs of cordless power tool users. AWS allows you to work with maximum efficiency, without the hazard of dust & leads. Featuring our legendary cordless technology, the AWS range has the power, speed & runtime to keep you ahead of the game.





18Vx2 18V + 18V 36V

# BRUSHLESS

## CUT THE CORD, NOT THE POWER.

Cut the cord and not the power with our 18Vx2 range of power tools. Our 18Vx2 range offers more power, speed and run-time without the hassles of a cord. The best part is our 18Vx2 lineup is fully compatible with all LXT® batteries and chargers. Tough out big jobs with 18Vx2 tools and go back to work with the worlds largest range of 18V power tools



# Product Objectives

- Expand the world's largest range of 18V power tools with our first line up of brushless 185mm circular saws
- Ideal for a wide range of trades requiring a large cut capacity circular saw with AC power without the cord



# Product Overview

Ergonomic design

18Vx2 Brushless

Dust extraction nozzle

Efficut blade



**AWS**<sup>\*</sup>  
Auto - start Wireless System

**ADT**

Large bevel with  
positive locks

Blower function

Twin LED job light

\* Feature applicable to DHS781 only

# Product Specification Sheet

## DHS780/781 – 18V Brushless Circular Saw



\* DHS781ZU shown above

	DH781	DHS780
Motor design	Brushless	Brushless
Blade diameter	185mm (7-1/4")	185mm (7-1/4")
Cut capacity	66mm	66mm
Blade Position	Right side	Right side
Bevel Capacity	56°	56°
No load speed	6,000rpm	6,000rpm
Overall length	342mm	342mm
Skin weight	3.46kg	3.46kg
Voltage	18Vx2	18Vx2

- **Ergonomic design** – improved control and comfort for the user
- **18Vx2 Brushless** – delivers superior performance that truly replaces the need for an AC powered saw thanks to a purpose built brushless motor and the power of 18Vx2 technology.
- **Dust extraction nozzle** – for connection to dust extraction vacuum
- **Efficut blade** – delivers superior performance with an advanced cutting design with no equal
- **Electric brake** – quickly stops the blade rotation after the switch has been disengaged
- **Twin LED job light** – for improved visibility in low light environments
- **Blower function** – helps to clear dust and away from the cut line
- **Large bevel with positive locks** – 56° bevel with positive stops at 22.5° & 45° for a wide range of applications
- **ADT (Automatic torque Drive Technology)** – automatically gives optimal rpm to torque ratio to produce the fastest cut in light or hard applications
- **AWS (Auto-start Wireless System)** – on demand dust extraction (DHS781 Only)



# Advantages

## Innovation



AWS for on demand extraction with DHS781

## Versatility



56° bevel with 22.5° and 45° positive locks

## Power



18Vx2 with ADT for unmatched performance

## Convenience



Blows dust from cut line + twin LED job light



# Advantages

The DHS781 can pair to our 18Vx2 Brushless AWS Dust Extraction Vacuum (DVC864L) thanks to the new Auto-Start Wireless System.

This feature enables automatic start up of the vacuum when the trigger is pulled on the tool for on demand dust extraction.

The DVC864L will also run for several seconds after the trigger has been released to pull any remaining material completely through the hose.

## How to pair your tools

1. Turn the DVC864L power dial to "AUTO."
2. Press and hold the  button on the DHS781 for 3 seconds until the light flashes **Green**.
3. Press and hold the  button on the DVC864L for 3 seconds until the light flashes **Green**.
4. Lights will turn to flashing **Blue** when the two units are paired.

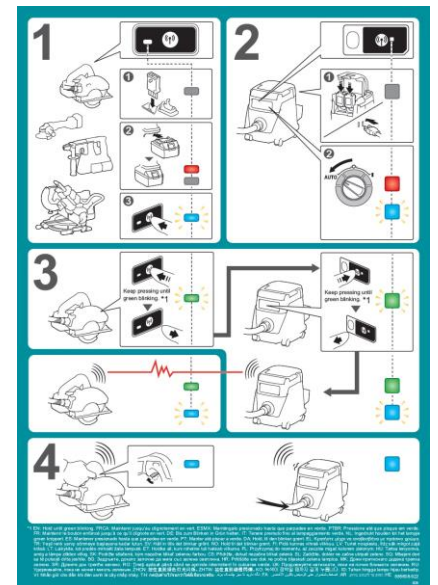

[Click Here for instructional video – Pairing Bluetooth Tools](#)



# Advantages

## Innovation driving you further

It is only innovation if its useful and our 18Vx2 Brushless 185mm circular saws come packed with more innovation than ever before to make life easier on the jobsite. Designed with the user in mind we packed these circulars saws with features like, an electric brake for added safety, a blower function that automatically clears your cut line from dust, positive locks for when bevelling for precision with ease, a flat motor housing for easy blade changes and much, much more.

**Electric brake rapid stops blade**



**Blower function clears cut line automatically**



**Positive locks for easy bevel changes**



**Flat motor housing for easy blade changes**



# Advantages

## Unrivalled technology, superior performance

Power through large cuts thanks to the combination of 18Vx2 technology and a purpose built brushless motor that delivers a no load speed 6,000rpm, backed by Automatic torque Drive Technology (ADT) for performance under load.

### ADT

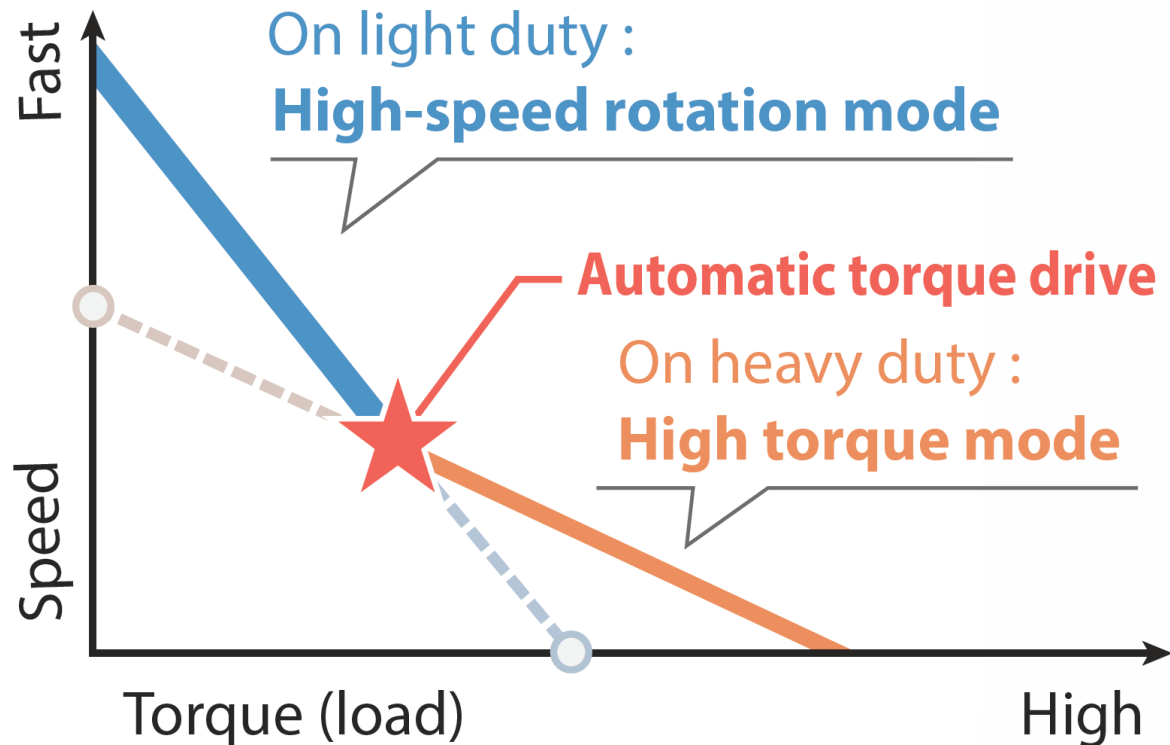

185mm Blade

# 66mm

Cut capacity at 0°





# Advantages

The DHS781 can pair to our 18Vx2 Brushless AWS Dust Extraction Vacuum (DVC864L) thanks to the new Auto-Start Wireless System.

This feature enables automatic start up of the vacuum when the trigger is pulled on the tool for on demand dust extraction.

The DVC864L will also run for several seconds after the trigger has been released to pull any remaining material completely through the hose.

## How to pair your tools

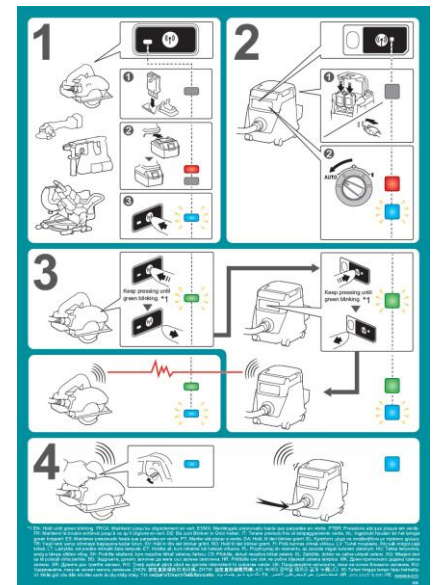

1. Turn the DVC864L power dial to "AUTO."
2. Press and hold the  button on the DHS781 for 3 seconds until the light flashes **Green**.
3. Press and hold the  button on the DVC864L for 3 seconds until the light flashes **Green**.
4. Lights will turn to flashing **Blue** when the two units are paired.



[Click Here for instructional video – Pairing Bluetooth Tools](#)



# Our Range

	DHS781	DHS780	DHS710
			
Motor design	Brushless	Brushless	Brushed
Blade diameter	185mm (7-1/4")	185mm (7-1/4")	185mm (7-1/4")
Blade Position	Right side	Right side	Right side
Bevel Capacity	56° (22.5° & 45° positive stops)	56° (22.5° & 45° positive stops)	50° (45° positive stops)
No load speed	6,000rpm	6,000rpm	4,800rpm
Overall length	342mm	342mm	356mm
Skin weight	4.13kg	4.13kg	3.93kg
Voltage	18Vx2	18Vx2	18Vx2
Electric Brake	Yes	Yes	Yes
Automatic Torque Drive	Yes	Yes	No
Auto-start Wireless System	Yes	No	No

# Accessories

## Standard Accessories



B-62044

Efficut 185mm 24T Blade



783204-6

Hex wrench



196520-1

Dust extraction nozzle



198901-5

Wireless Unit  
(DHS781 ONLY)

## Optional Accessories



B-62044

Efficut 185mm 24T Blade



199386-8

Tool hanger