

Pink® Building Blanket, Permastop® Building Blanket Permastop® Tropic Building Blanket Permatuff™ Building Blanket, Resituff™ Building Blanket Pink® Sonomatt® Blanket

Application

This installation guide applies to Pink® Building Blanket, Permastop® Building Blanket, Permastop® Tropic Building Blanket, Permatuff™ Building Blanket, Resituff™ Building Blanket and Pink® SonoMatt® Blanket in commercial and residential roofing and walling.

Important Notes

Pink® Building Blanket insulation is supplied in rolls to allow easy installation along roofs and down walls. When this product is unfaced, it is referred to as Pink® Building Blanket. When it has a facing on one or two surfaces, it is known as either Permastop® Building Blanket, Permastop® Tropic Building Blanket, Permatuff™ Building Blanket, Resituff™ Building Blanket or Pink® SonoMatt® Blanket®.

- All insulation shall be installed in accordance with AS 3999:2015.
- Refer to the latest ICANZ installation handbook Part 2: Professional Installation Guide for further information and tips.
- Ensure that all safety assessments are carried out relevant to the project and all site safety requirements are strictly adhered to.
- Electric cables and equipment partially or completely covered with bulk thermal insulation may overheat and fail. Refer to AS 3999:2015 – Section 2.6 for details.
- Permastop® Building Blanket, Permastop® Tropic Building Blanket, Permatuff™ Building Blanket and Resituff™ Building Blanket products are manufactured with a foil laminate that is electrically conductive – care must be taken when installing these products near electrical wiring and luminaires – always consult a qualified Electrician if in doubt.
- Prior to installation, calculate the amount of insulation and fixings required for the installation.
- All Pink® Building blanket products must be protected from rain or adverse weather conditions and kept completely dry prior to, during and after install.
- Avoid gaps in the insulation, other than where required such as around electrical fittings or as specified.
- Avoid compressing or over fixing insulation as this will reduce the thermal performance of the installed product.
- Avoid using multiple small offcuts to fill single areas and opt for larger single pieces, purpose-cut to fill larger gaps.
- Reflective Foil products require a minimum of 20mm still air cavity in order to adequately perform thermally. Tears and penetrations shall be sealed with Vapastop® 883 Reinforced Foil Tape or equivalent.
- Alkali products are liable to corrode aluminium foil; hence the foil surface shall not be used/in contact with wet concrete/mortar or corrosive atmospheres.
- Where cutting is required, use a sharp knife and straight edge, cutting with power tools is not recommended.
- For commercial roofing applications where spans are greater than 900mm, support (safety mesh or similar) must be provided below the insulation.
- All Pink® insulation products are not designed to withstand weathering; hence external cladding should be applied without delay. These insulations products are not suitable for applications where subject to wetting or excessive moisture.

Insulation required

- Measure the square metre of area to be insulated.
- Refer to the project specification for the correct insulation. Building blankets are generally selected on density and thickness to achieve a certain thermal and acoustic performance.
- Coverage for each pack of building blanket rolls are provided on the relevant Technical Data Sheet.
- Divide the area to be insulated by the coverage per pack to determine the number of packs to order.
- Allow for wastage. As a general rule, allow for 5% wastage for simple areas and greater allowances for more complex areas.

Accessories

- Generally, all Pink® Building Blankets will stay in place when installed prior to wall sheeting being installed.
- Any stringing selected should minimise the unevenness of contact of the plasterboard against the framing.
- Suitable sized Roof Razor® insulation spacer is recommended for optimal Pink® Building Blanket thermal performance in commercial roofs.

Tools



Sharp knife

With a plastic (non-conductive) handle for cutting insulation to size.

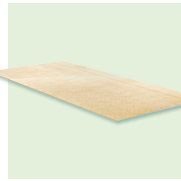

Cutting board

Or hard, durable surface.



Straight edge

For cutting.

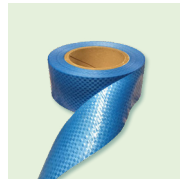

Tape or string

If installing from underside of ceiling or if wall insulation is to be left for an extended period.



Tape measure

To measure lengths required.



Clothing & PPE

Appropriate wear for site (refer below).



Ladder

Or scaffolding as needed.

PPE

Personal Protective Equipment (PPE) must be compliant with the requirements of the specific worksite and relevant Australian Standards. Check with site foreman or site representative to ensure that required PPE obligations are met. As a recommendation for handling and installing insulation materials, the following PPE is recommended:



Eye protection

Suitable eye protection to AS 1336 reduces the risk of eye contact with dust or fibres. Safety glasses must be worn when installing from beneath the ceiling.



Gloves

Gloves are recommended, especially when cutting insulation.



Work clothes

Loose fitting clothes, including long sleeved shirts, long pants and cap or hard hat.



Dust mask

A dust mask is recommended when working in dusty areas.



Safety shoes

Safety boots/shoes must be worn to protect feet.

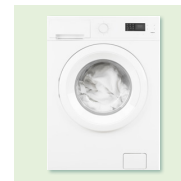

Separate wash

Wash work clothes separately and rinse the washing machine after use.

Safety

The following activities are recommended but not limited to these items. A full site-specific safety assessment must be completed to ensure installation is safe.



Assess

Assess the building structure and site for any safety issues prior to commencing work.



Check

Before entering a ceiling space, make note of the location of equipment in the ceiling such as lighting luminaires, exhaust fans and fire sprinklers.



Electrical wires

Ensure the work area is safe from hazards including electrical cabling. Do not touch any live electrical cables.



Isolate power

If accredited, isolate power at the circuit board where necessary and apply caution tags to circuit breakers.



Electrician

If not accredited, ask appropriate site representative to isolate power at the circuit board where necessary and apply caution tags to circuit breakers.



Height

Working at height can be dangerous, exercise caution when climbing ladders or accessing elevated platforms.



Stay hydrated

Stay hydrated and get relief and fresh air regularly.

Residential roofing

- Foil surfaces shall face inward, except in tropical climates where foil is supplied on both sides of the blanket for greater condensation control.
- Foil laps permit joins to be concealed, for ease of installation each consecutive roll shall be rolled over the lap ensuring the glasswool is butted firmly against the adjacent roll.
- Foil faced building blanket shall be lapped not less than 150mm at all side and end joints.
- Check metal roof manufacturer's recommendation on maximum insulation thickness before installation.
- Anti-glare surfaces shall always face upward.
- Pink® building blanket products may be installed over roof battens ensuring the bulk insulation is continuously in contact with the underside of the roof sheeting.
- Allow adequate sag to ensure blanket recovers to its nominal thickness
- Pink® building blanket products may be laid ridge to gutter or parallel to gutter.
- Special care shall be taken to avoid tearing or puncturing the facing membrane during its installation, such as by contact with cut edges of gutters or roof sheets. The facing membrane shall be properly cut around obstacles, and all openings shall be sealed with Vapastop® 883 Reinforced Foil Tape
- If foil layer is required to be a vapour control and/or air control layer, it is required that the foil be lapped and taped at joins as per AS/NZS 4200.2.

Figure 1: Vertical installation

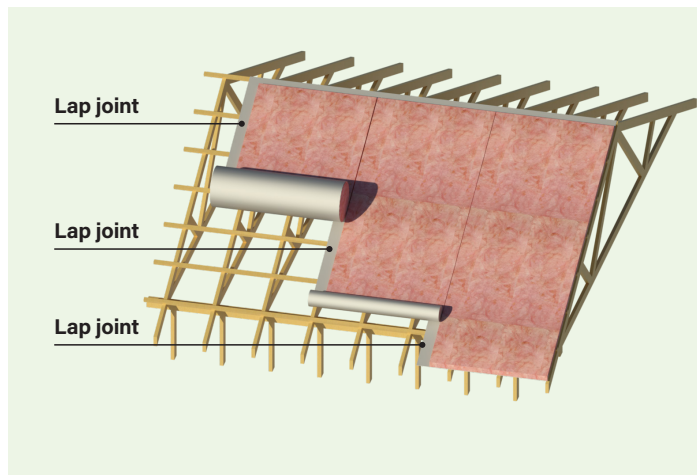
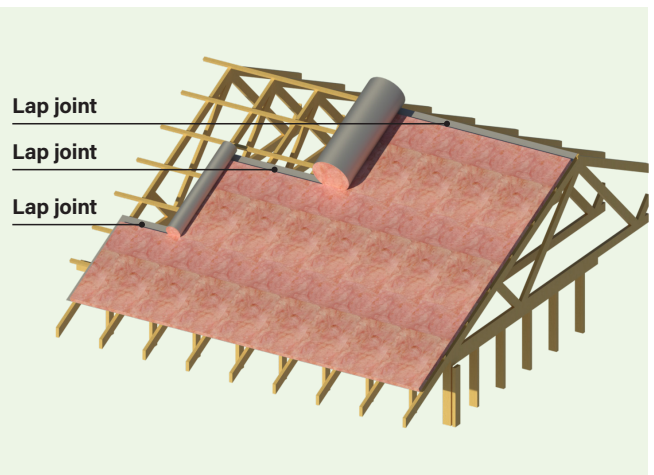

Figure 2: Horizontal installation



Residential fascia and guttering detail

- Bulk insulation of Permastop®, Permatuff™ and Resituff™ should be trimmed at the external edge of the fascia leaving foil to extend an approximate 25mm section draping into the gutter for roof pitch above 10 degree. Refer to **Figure 3**.
- On lower pitch (<10°) roof, it is recommended that Permastop®, Permatuff™ and Resituff™ is folded back, or the bulk insulation trimmed, and the foil is folded over the blanket in a 'bull nose' fashion, anti-ponding board to be installed where needed. Refer to **Figure 4** and **Figure 5**.
- AS 3959 should be consulted for the appropriate install method under corresponding BAL rating.
- Please ensure that the bulk insulation component does not drape into the gutter, this may allow for water to enter the roof cavity and voiding warranty.

Figure 3: Correct gutter trim

Trim bulk insulation and allow foil only to drape into the gutter

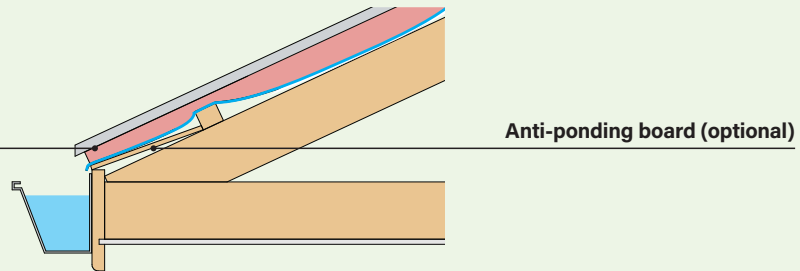

Figure 4: Gutter trim low pitch (<10°) Option 1

Trim bulk insulation and allow foil only to drape into the gutter

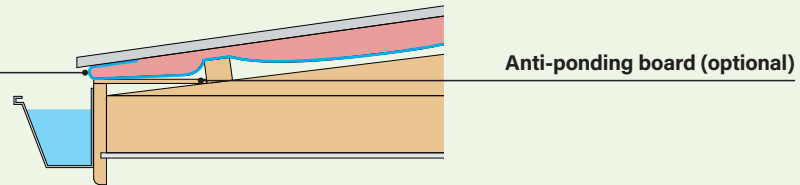
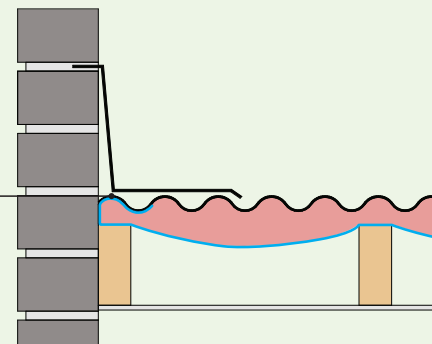

Figure 5: Apron trim

Fold over 150mm of foil, trimming and removing bulk insulation as required



Valleys

- Trim back the bulk insulation to reduce the risk of the edge meeting the water pathway.
- The bulk insulation can be folded back from the flashing, leaving the foil at the flashing edge, however not in the water path.

Commercial roofing

Unfaced blanket (refer to Figure 6): Pink® Building Blanket

- If installing a vapour barrier beneath the blanket, it must be laid over the purlins/mesh (with anti-glare side facing upward) in the same manner as safety mesh. A lap of 150mm is required at joins and sealed with Vapastop® 883 Reinforced Foil Tape or double sided cloth tape.
- Lay the blanket over the vapour barrier.
- Butt the blankets firmly together at the side and end joins.
- Fit the blanket tightly around roof protrusions. Fill gaps with off-cuts to prevent thermal bridging.
- Use Roof Razor® insulation spacers fixed to the purlins to allow the blanket to recover to its nominal thickness.
- Fix metal roof cladding to purlins with fasteners via the insulation spacer (see fixing method points above).

Figure 6: Flat commercial roof with unfaced blanket

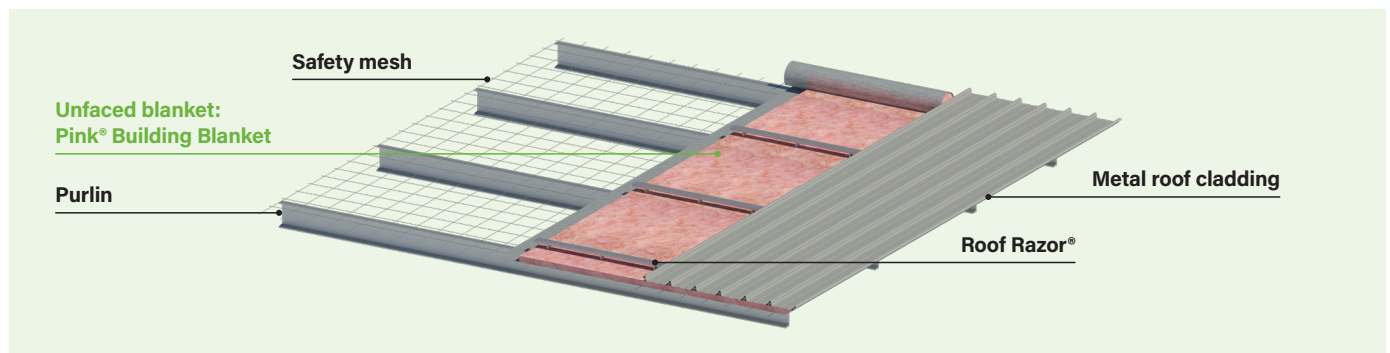

Commercial roofing

Foil faced blanket (refer to Figure 7): Permastop® Building Blanket and Permatuff™ Building Blanket

- Foil surfaces shall face inward, except in tropical climates where foil often faces outwards for condensation control.
- When the foil surface is exposed internally, care shall be taken to not excessively crease the foil surface prior to and during installation.
- Where internal aesthetics are important in roofs located in tropical climates, we recommend the blanket is laid with the reflective surface facing inwards and an additional layer of Sisalation® reflective foil laminate is laid above the blanket prior to fixing the metal deck roof.
- For commercial roof spans greater than 900mm, support (safety mesh or equivalent) must be provided below the Permastop® Building Blanket.
- Pink® Building Blanket products shall be laid over the purlins in the same manner as the wire mesh (reflective surfaces to face inwards into the airspace below).
- Foil laps permit joins to be concealed. For ease of installation, each consecutive roll shall be rolled over the lap ensuring the glasswool is butted firmly against the adjacent roll.
- When a vapour barrier is required, joins in foil surfaces shall be sealed with Fletcher Insulation Vapastop® 883 Reinforced Foil Tape or double sided cloth tape.
- Roof Razor® insulation spacers should be fixed to the purlins when using either the pierced fix roof cladding or the concealed fix roof cladding method.
- Fix metal roof cladding to purlins with fasteners via the insulation spacer (see fixing method points above) to allow the blanket to recover to its nominal thickness.

Figure 7: Pitched commercial roof with foil faced blanket

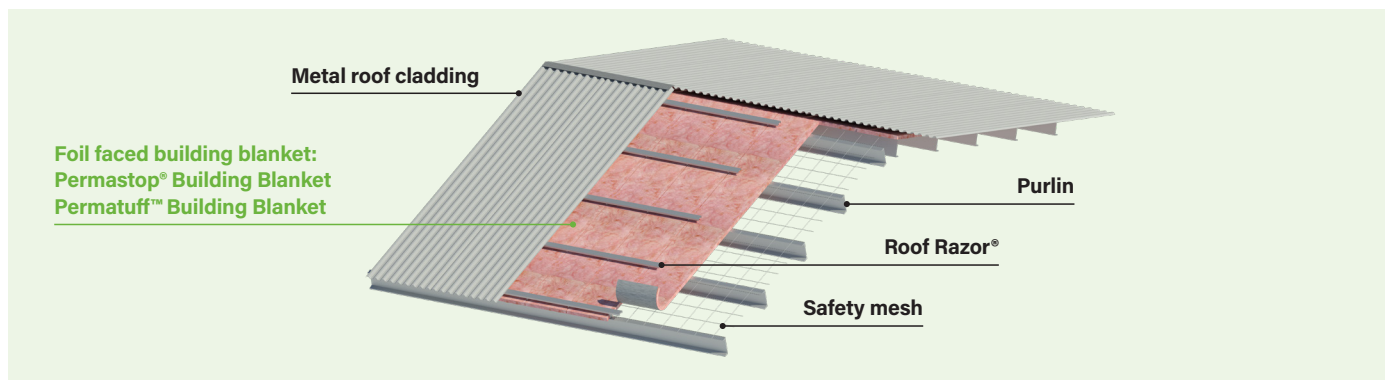

Commercial metal clad walls

Unfaced blanket (refer to Figure 8): Pink® Building Blanket

- Drape the building blanket from the roof line to the ground, trimming length where necessary.
- Working from the roof line down, fix external cladding to girts via Roof Razor® insulation spacer, (or alternative suitable methods as advised by facade manufacturer), leaving enough slack in the Pink® Building Blanket to recover to its nominal thickness between the girts and the cladding.
- Butt Pink® Building Blanket firmly at joins.
- Ensure there are no gaps across the wall surface area, to avoid thermal bridging.
- The use of a moisture vapour barrier on the warm side of the structure shall be considered to prevent condensation from occurring. The vapour barrier needs to be taped with Vapastop® 883 Reinforced Foil Tape or double sided cloth tape.

Figure 8: Commercial metal clad wall

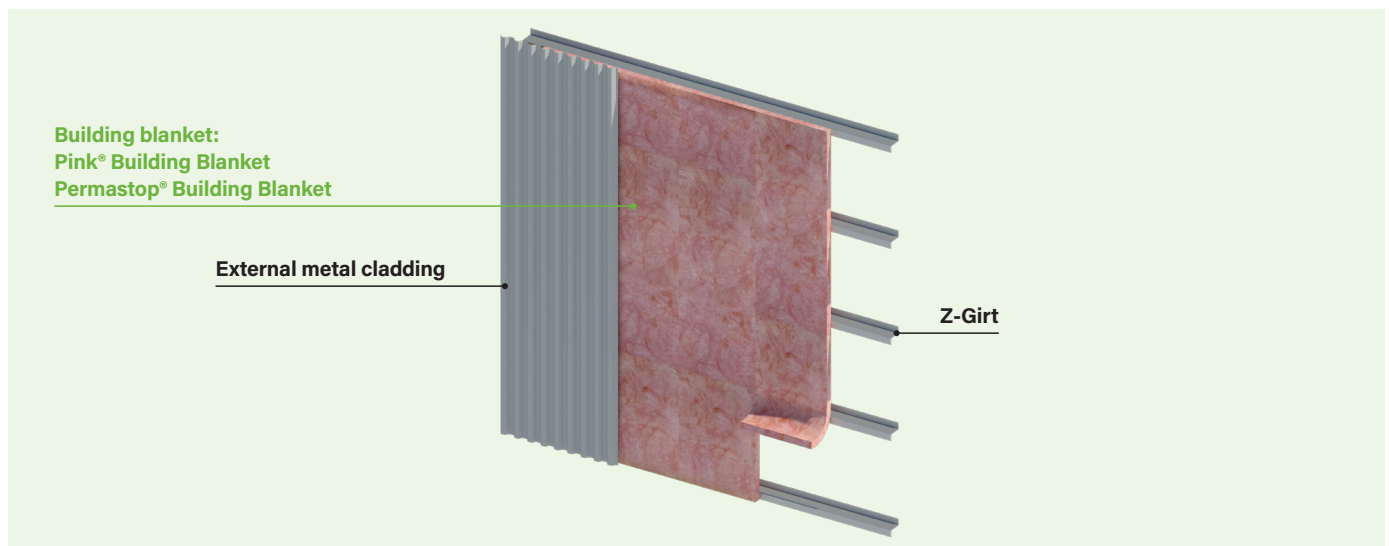

Foil faced blanket (refer to Figure 8): Permastop® Building Blanket and Permastop® Tropic Building Blanket

- Drape the Building Blanket from the roof line to the ground, trimming length where necessary and ensuring 150mm overlap is facing the direction where the next roll is to be installed.
- Ensure the two glasswool side edge surfaces of the building blanket abut firmly at joins and a continuous vapour barrier is achieved. The 150mm foil lap will transfer over the initial 150mm of the consecutive roll where it is to be sealed using a vapour impervious tape.
- Working from the roof line down, fix external cladding to girts via Roof Razor® insulation spacer, (or alternative suitable methods as advised by facade manufacturer), leaving enough slack in the building blanket to recover to its nominal thickness between the girts and the cladding.
- Ensure there are no gaps across the wall surface area, to avoid thermal bridging.

Taping guidance for Permastop® Building Blanket

- Apply Fletcher Insulation double sided cloth tape to the outer edge of the 150mm foil overlap ensuring strong adhesion is achieved by applying adequate pressure.
- Shortly before laying the consecutive roll of Permastop® Building Blanket, remove the protective strip from the double sided cloth tape.
- Carefully roll out the consecutive roll of Permastop® Building Blanket over the previous lap ensuring the two glasswool surfaces abut and a continuous vapour seal is achieved.

Decorative acoustic applications

Fabric faced blanket: (refer to Figure 9): Pink® SonoMatt® Blanket

- Pink® SonoMatt Blanket® may also be fixed behind perforated linings to provide decorative acoustic absorption and to conceal the substrate behind the lining for an enhanced visual appearance.
- Framing and fixings for the metal linings shall be designed to accommodate the depth of the insulation, while supporting the weight and holding the insulation boards in place.

Figure 9: Decorative acoustic ceiling application

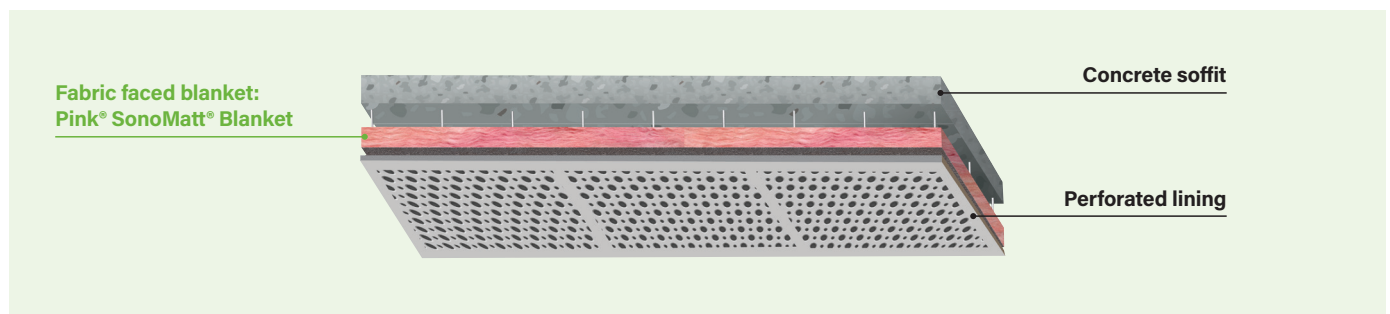

Note: if your application/installation is outside these guidelines, please contact Fletcher Insulation prior to commencing the install to obtain written approval for your specific application.

© Fletcher Insulation Pty Limited 2024. Fletcher Insulation reserves the right to change product specifications without prior notification. Information in this publication and otherwise supplied to users as to the subject product is based on our general experience and is given in good faith, but because of the many particular factors which are outside our knowledge and control and affect the use of products, no warranty is given or is to be implied with respect to either such information or the product itself, in particular the suitability of the product for any particular purpose. The purchaser should independently determine the suitability of the product for the intended application. The colour PINK, Pink® and Pink® Batts are registered trademarks of Owens Corning used under licence by Fletcher Insulation. FBS-1 Glasswool Bio-Soluble Insulation® is a registered trademark of ICANZ. Unless otherwise stated all ™ and ® are trademarks and registered trademarks of Fletcher Insulation Pty Limited ABN 72 001 175 355. IG01_Revision_3_Issue Date 16052024.

For more information: phone 1300 654 444 email info@insulation.com.au
visit insulation.com.au

PermaStop
PREMIUM ROOFING BLANKET

PermaTuff
COMMERCIAL ROOFING BLANKET

ResiTuff
RESIDENTIAL ROOFING BLANKET